

ATLANTIC SOFT CLOSE HINGE

530 Glass to wall for 10mm (3/8") - 15mm (19/32") glass

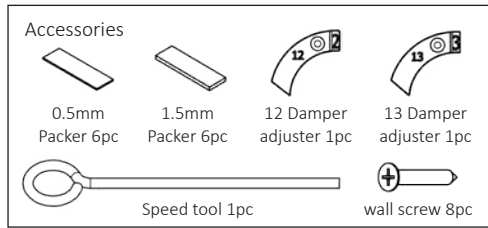

Installation

1. Check the wall or post alignment, making sure it is plumb and level. Also make sure the glass latch panel or post is plumb and in alignment.



Watch the install video



4. Place the gate panel with the fixed hinges into position on some timber blocks at the desired level and make sure it is plumb.

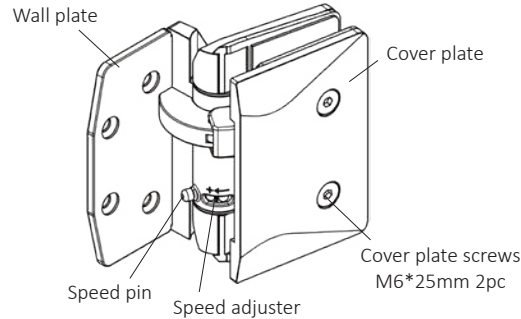
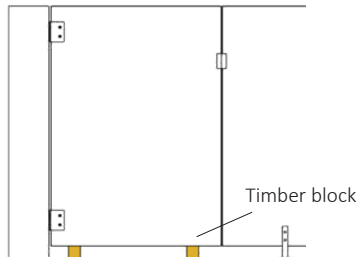

BACK- inside

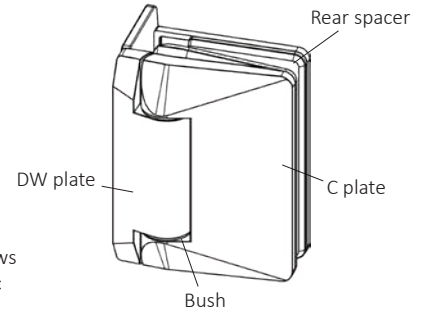

FRONT- outside

2. Undo the cover plate screws completely, then screw them back in 2 to 3 turns. For 12mm (1/2") and above panel thickness, remove the rear spacer. For 10mm (3/8") panel leave the rear spacer in.

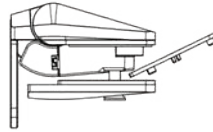

5. Pre drilling the holes for harder timbers or masonry. Then secure the first 2 wall screws on the top hinge into the timber. Repeat for the lower hinge. Carefully open the gate and secure the other 2 screws on each hinge.

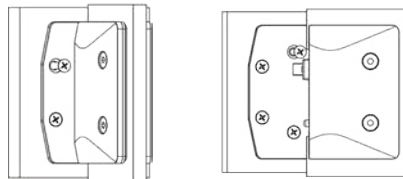

3. Take one hinge and slide it into the gate panel. With the hinge in the center of the cutout push all the way to the back of the cutout tighten the cover plate screws. Repeat these steps for the lower hinge.

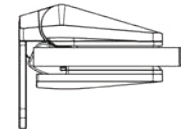

6. Push packers in above the hinge for the glass to rest on. They should be pushed in past the level of the glass (see diagram). Repeat step 6 for bottom hinge.

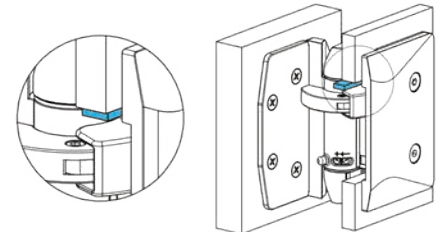



530 Glass to wall for 10mm (3/8")- 15mm (19/32") glass

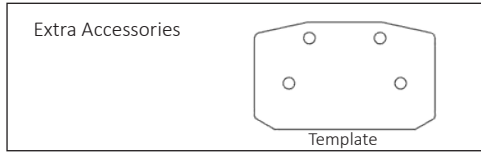

MASONRY WALL INSTALLATION

These instructions must be followed or the warranty will be voided.

Installation

1 to 4. Follow steps 1 to 4 from the standard installation instructions, then follow on from here.



Watch the install video

4a. With the gate and hinges in position, mark the 2 visible holes on both hinge. (Warranty will be voided if masonry walls are drilled with hinges in place.)

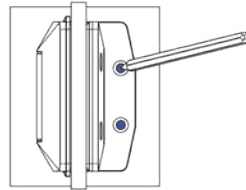

4b. Move the gate with hinges out of the doorway. Then use the included template to mark the other 2 holes for both hinges.

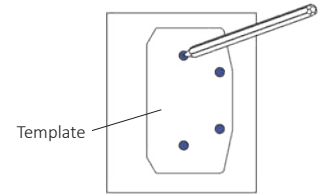

4c. With the gate still moved out of the doorway, drill all four holes and repeat for the second hinge. Then install your wall plugs.

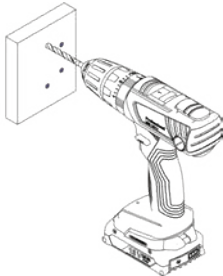

5. Move the gate with hinges back into position. Then secure the first two wall screws on the top hinge. Repeat for the lower hinge. Carefully open the gate and secure the other two screws on each hinge.

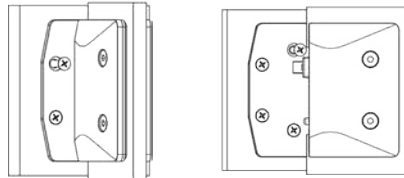

6. Push packers in above the hinge for the glass to rest on. They should be pushed in past the level of the glass (see diagram). Repeat step 6 for bottom hinge.

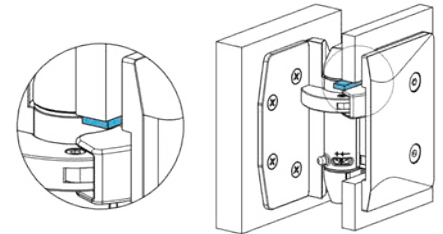



Watch the install video

530 Glass to wall for 10mm (3/8") - 15mm(19/32) glass

NOTE: Speed or damper adjustments should only be done after the hinges are installed.

In most cases, the hinges will not need any adjustment.

WATCH VIDEO atlantichinge.com/install

Increasing speed

1. Insert the speed tool all the way into the speed adjuster at the base of the arrow.

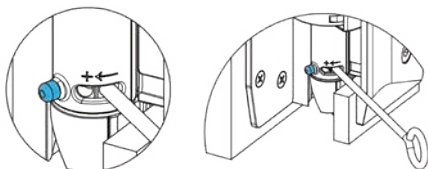

2. Apply pressure on the speed tool in the + symbol direction until you can remove the speed pin. Then push the tool to the + symbol to increase speed.

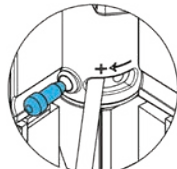

3. Insert the speed pin all the way back in, release the pressure of the speed tool and remove it.

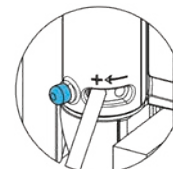

Reducing speed

1. Insert the speed tool all the way into the speed adjuster at the + symbol.



2. Apply pressure in the + direction on the speed tool until you can remove the speed pin. Then allow the tool to rotate to the base of the arrow to reduce speed.

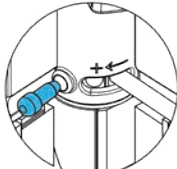

3. Insert the speed pin all the way back in, release the pressure of the speed tool and remove it.

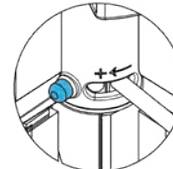

Damper adjustment

Damper adjusters are numbered. The larger the number, the more damping. 15 is the highest and 12 is the lowest.

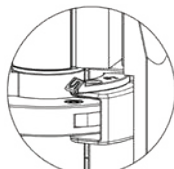

1. Open the gate and slide out the damper adjuster.

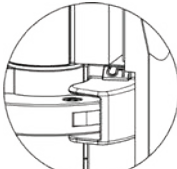

2. Insert the damper adjuster. Push in all the way.

TROUBLESHOOTING CHECKLIST

Squeak Noise - Check the spigots as they can cause this noise in some circumstances.

Door closing slowly - Check hinge panel alignment and speed adjustment and damper adjustment. If the problem persists, please contact Atlantic Hinge.

Door slamming - Check damper adjustment and reduce closing speed. If the problem persists, please contact Atlantic Hinge.